



**CONSUMERS ENERGY'S FORESTRY OPERATIONS
2025 COMMUNITY STREET & BOULEVARD TREE PLANTING GRANT PROGRAM
GRANT APPLICATION
APPLICATION DUE DATE JULY 18, 2025**

[Return completed application to Becky Wildenthal at cetreeplantinggrants@gmail.com](mailto:cetreeplantinggrants@gmail.com)

General Information:

Applicant Name (City/Village)	Contact Person Name
Address	E-Mail
Address2	Telephone
City, State, ZIP	Estimated Project Starting Date
Federal Employer Identification Number (FEIN)	Estimated Project Completion Date (must be completed by November 11, 2022)
Total Project Costs	Grant Amount Requested

Project description - Please respond as concise as possible. Attach additional pages as needed:

Purpose of the Project
Please List Other Partners/Volunteer Groups Associated with this Project

If Utilities are Present HOW will this Tree Planting Program AVOID Conflicts with Existing Utilities?

Planting List: List location, tree species, caliper size, and type (bareroot/b&b/container) of trees being purchased for this project.

Location on site plan	Tree Species w/Variety/Cultivar	Size	Type	Number	Are overhead utilities present	Are underground utilities present

Tree Planting: Call MISS DIG at 811 or email at <https://www.missdig.org> when planning any tree planting or digging project

Please attach the required documentation as follows (Reference the attached sample application for more information):

- 1. Map of site plan with tree locations labled**
- 2. Ground pictures of proposed planting locations that include any overhead facilities**

I hereby agree, as Designated Representative of the above named applicant, to implement this project according to the Application, to abide by the provisions of the Consumers Energy Community Street & Boulevard Tree Planting Grant Program, including compliance with all applicable federal and state laws and regulations.

Applicant Name

Applicant Signature

Date

My City Tree Grant

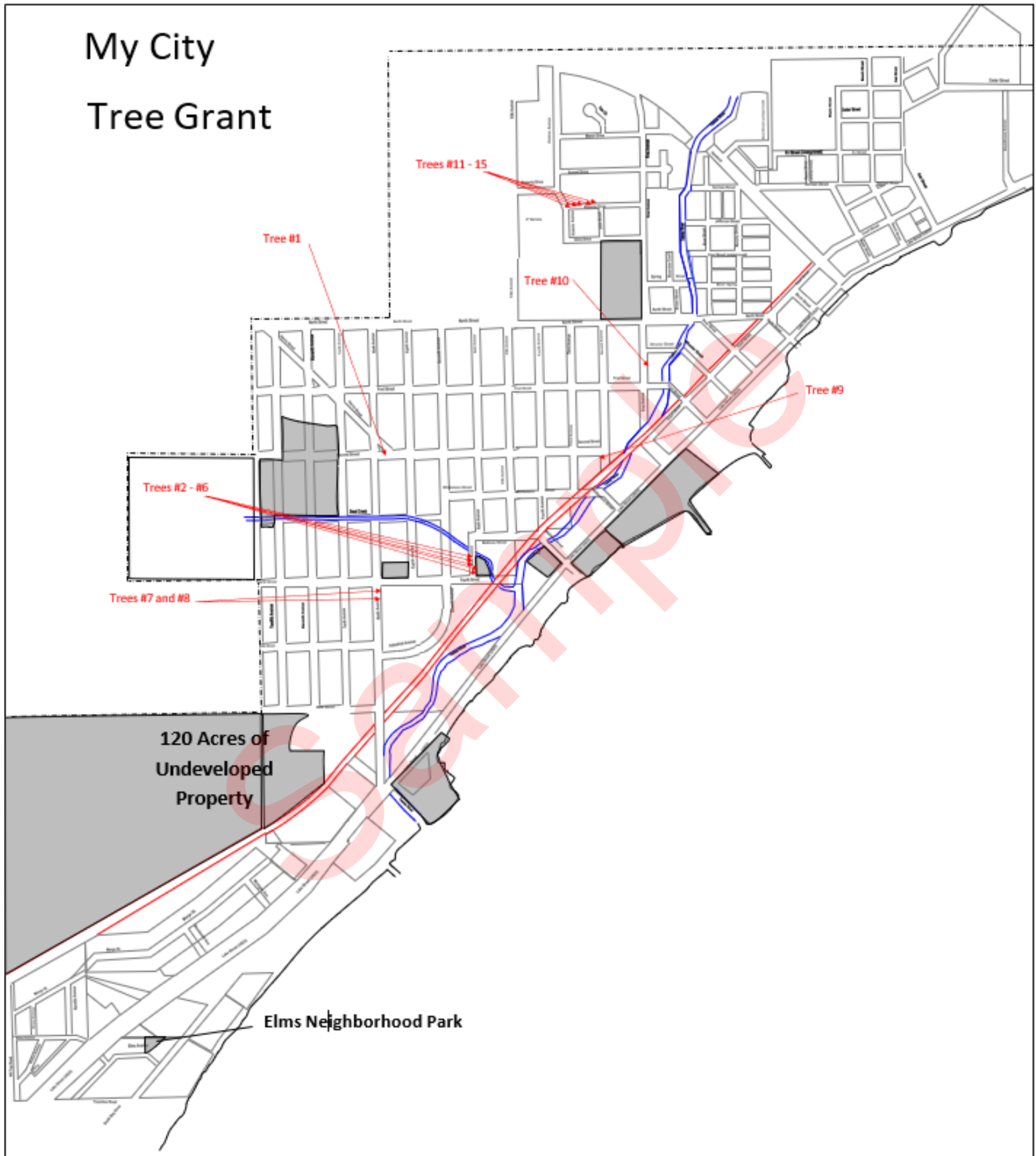

Tree #1 and #2 will be placed in the Right of Way at the intersection of Seventh and Whittemore. There are no overhead lines or underground utilities.



Tree #3 will be placed in the Right of Way in front of 400 First Ave. The tree will be placed so there is no interference with underground utilities. There are no overhead lines.



Trees #4 and #5 will be placed in the Right of Way in front of 140 Roberta Drive. There are no overhead lines or underground utilities.



Tree #6 and #7 will be placed in the Right of Way in front of 420 First Ave. There are no overhead lines or underground utilities.



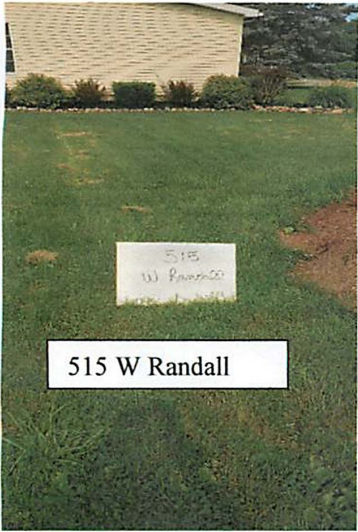

515 W Randall

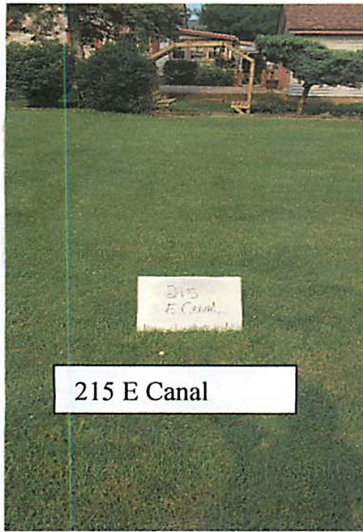

215 E Canal

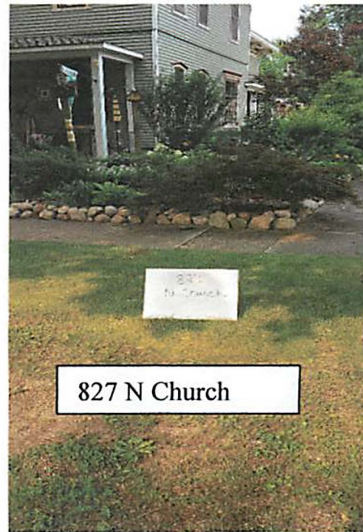

827 N Church

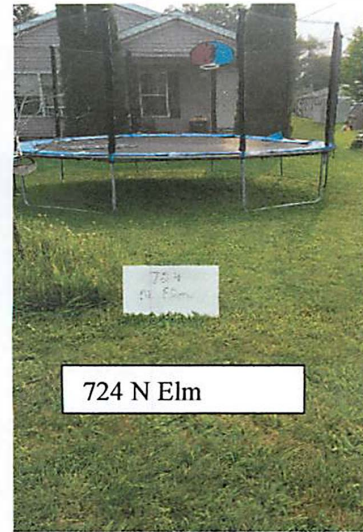

724 N Elm

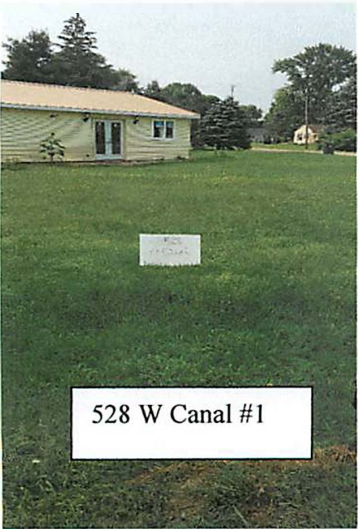

528 W Canal #1



528 W Canal #2

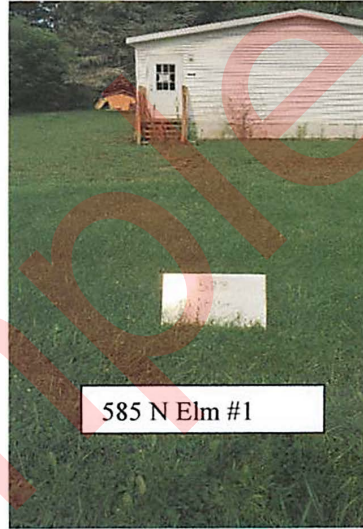

585 N Elm #1



585 N Elm #2

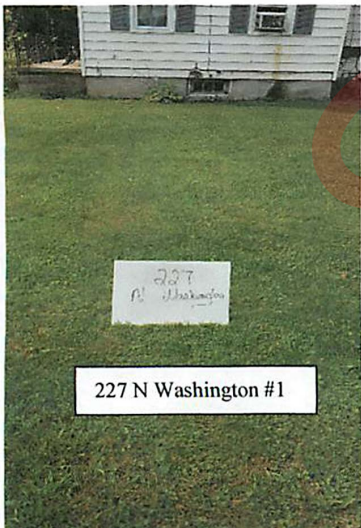

227 N Washington #1

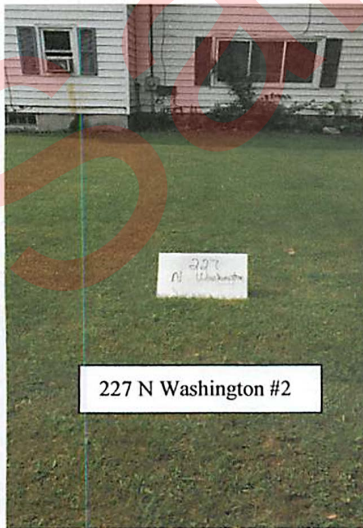

227 N Washington #2



585 N Elm #2